

FONTE DE AGUA 1  
 COORDENADAS  
 LAT: -7.138499°  
 LONG: -41.377856°

INICIO  
 COORDENADAS  
 LAT: -7.271947°  
 LONG: -41.212087°

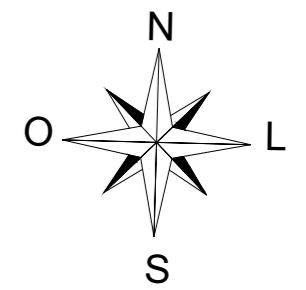
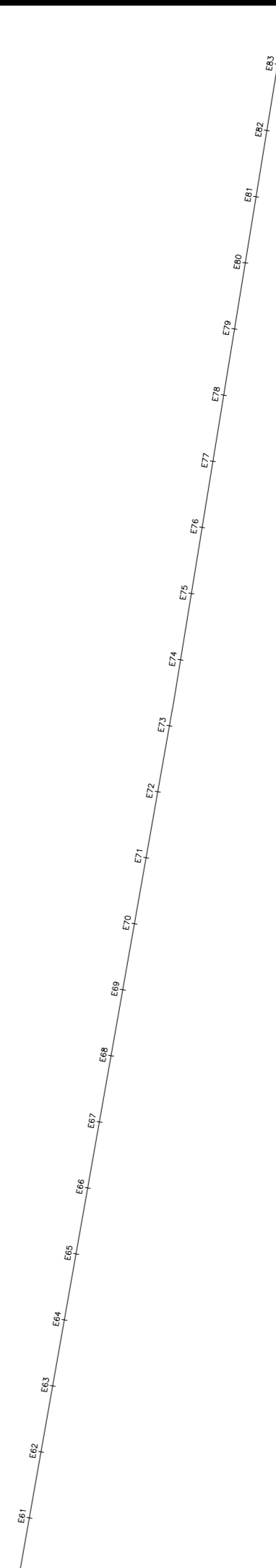
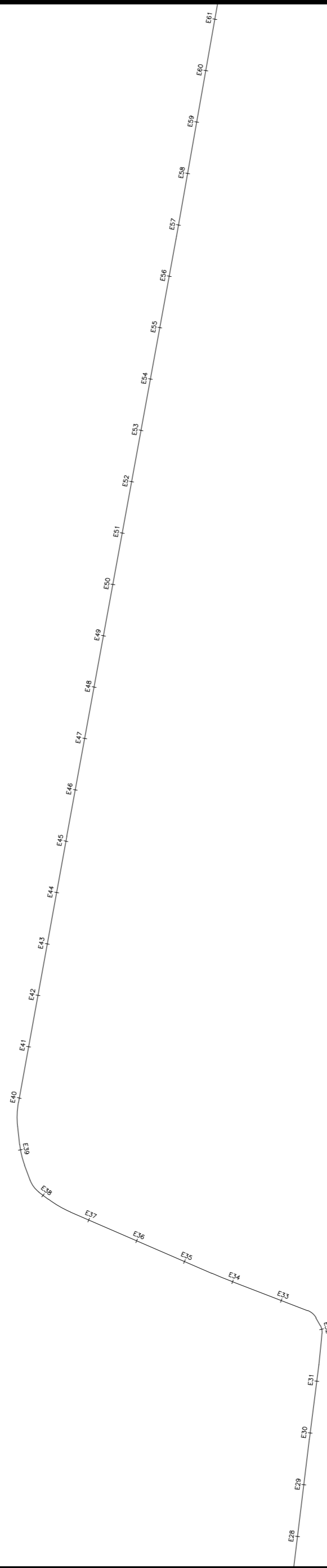
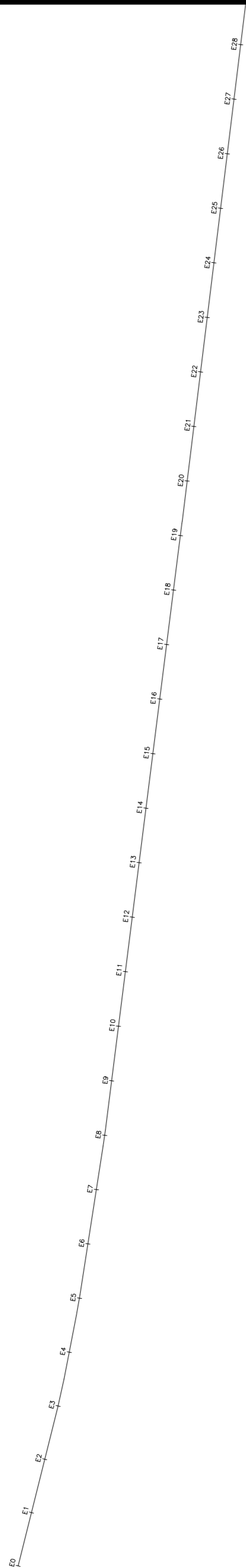

GOVERNO DO ESTADO DO PIAUÍ  
 SECRETARIA DE ESTADO DO TURISMO - SETUR

OBRA: RECUPERAÇÃO DE ESTRADAS VICINAIS GEMINIANO - PI  
 PROJETO: PLANTA BAIXA - PERFIL LONGITUDINAL  
 TRECHO 1: MILHÃS A BENTIVI

ESCALAS:  
 INDICADAS

DATA:  
 2023

AUTONOMIA DO PROJETO:  
 Juliano Lopes de Oliveira Moura Fé  
 Engenheiro Civil

  
 Juliano Lopes de Oliveira Moura Fé  
 ENGENHEIRO CIVIL  
 CREA-PI 19188/2023

PRANCHA:  
**1/16**

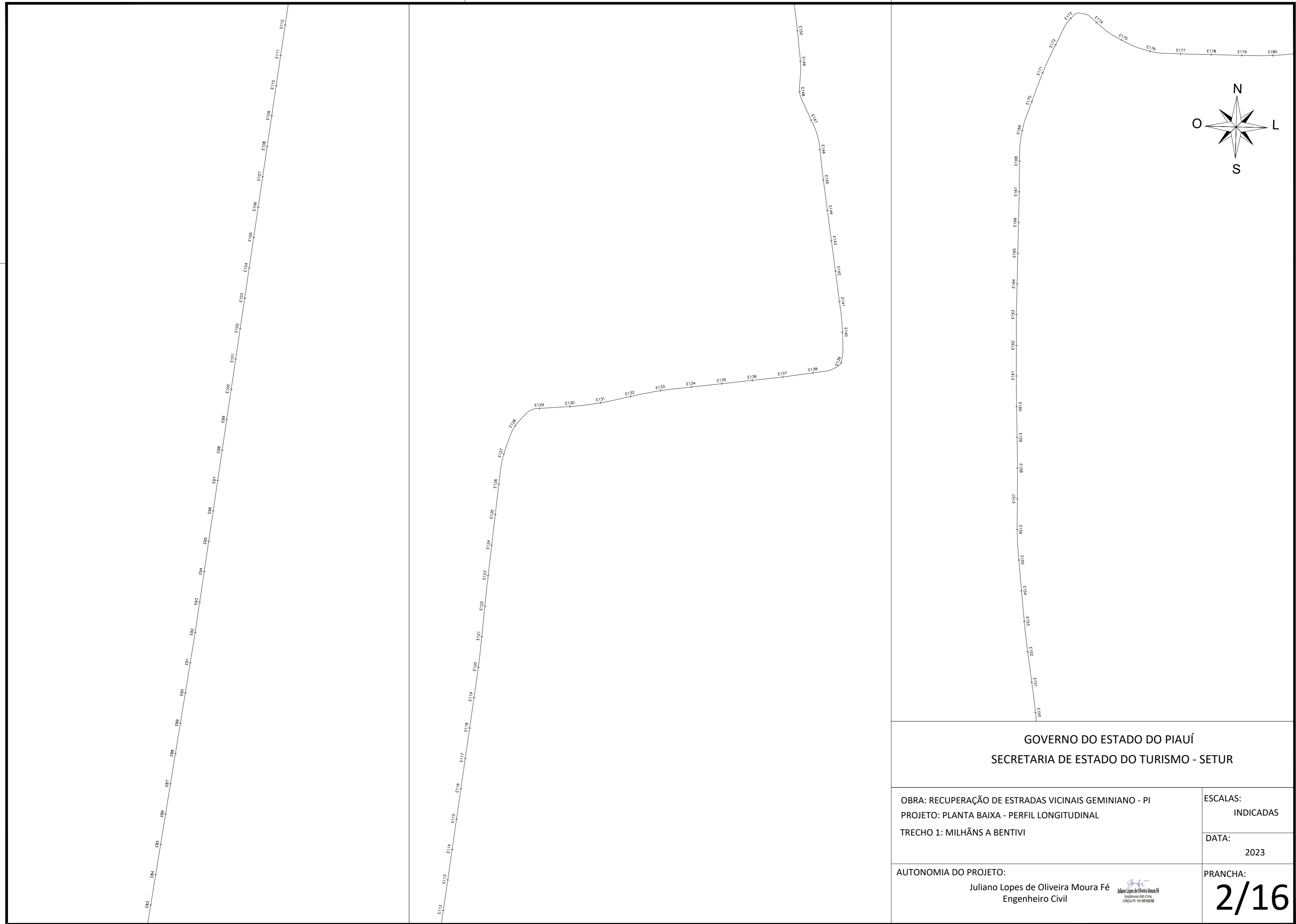

GOVERNO DO ESTADO DO PIAUÍ  
SECRETARIA DE ESTADO DO TURISMO - SETUR

OBRA: RECUPERAÇÃO DE ESTRADAS VICINAIS GEMINIANO - PI  
 PROJETO: PLANTA BAIXA - PERFIL LONGITUDINAL  
 TRECHO 1: MILHÃS A BENTIVI

ESCALAS:  
INDICADAS

DATA:  
2023

AUTONOMIA DO PROJETO:  
 Juliano Lopes de Oliveira Moura Fé  
 Engenheiro Civil



PRANCHA:  
**2/16**

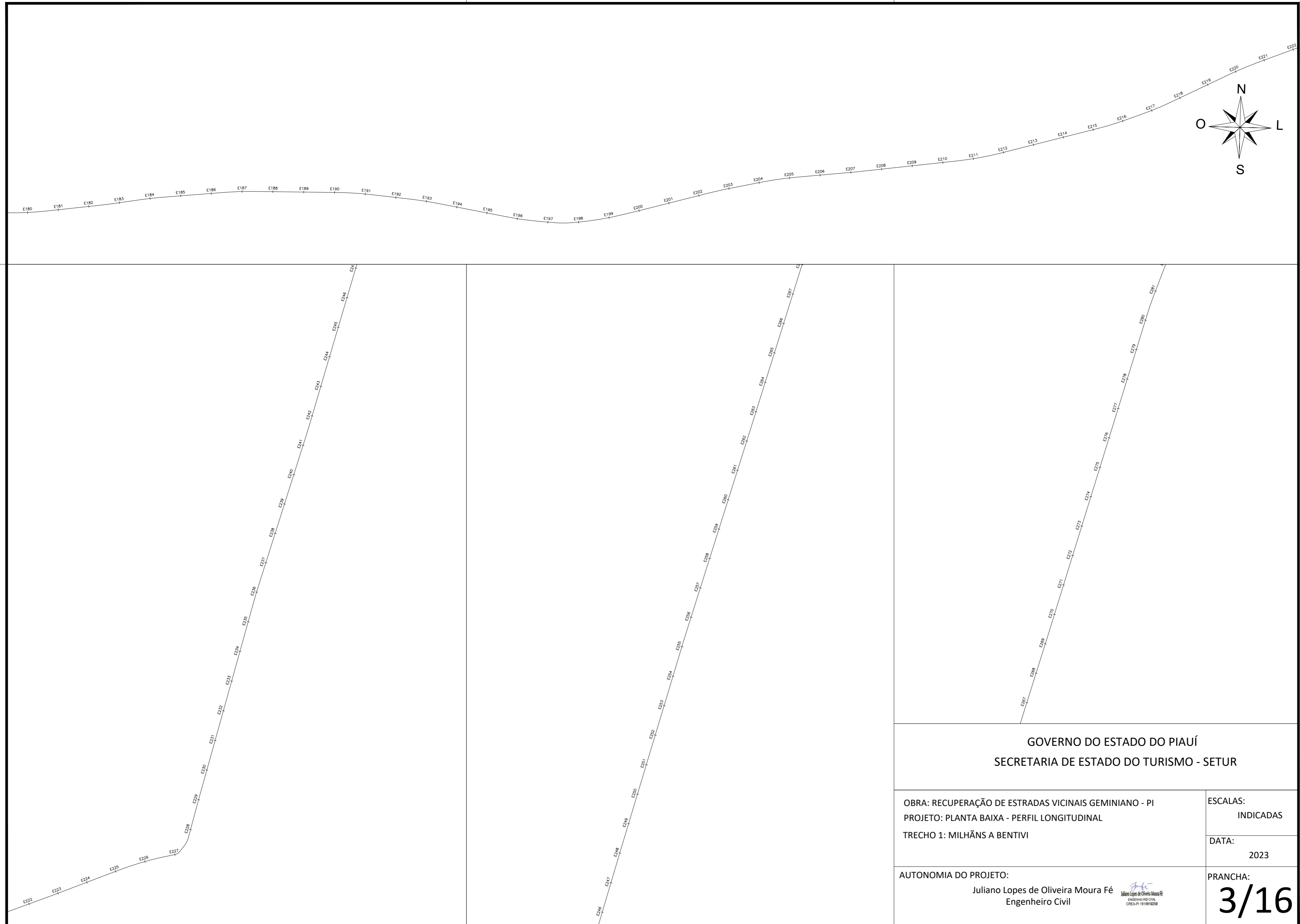

GOVERNO DO ESTADO DO PIAUÍ  
SECRETARIA DE ESTADO DO TURISMO - SETUR

OBRA: RECUPERAÇÃO DE ESTRADAS VICINAIS GEMINIANO - PI  
PROJETO: PLANTA BAIXA - PERFIL LONGITUDINAL  
TRECHO 1: MILHÃS A BENTIVI

ESCALAS:  
INDICADAS

DATA:  
2023

AUTONOMIA DO PROJETO:  
Juliano Lopes de Oliveira Moura Fé  
Engenheiro Civil



PRANCHA:  
**3/16**

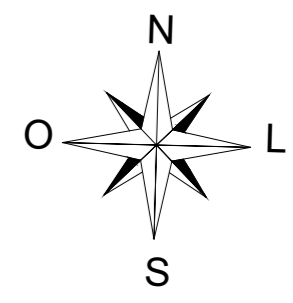
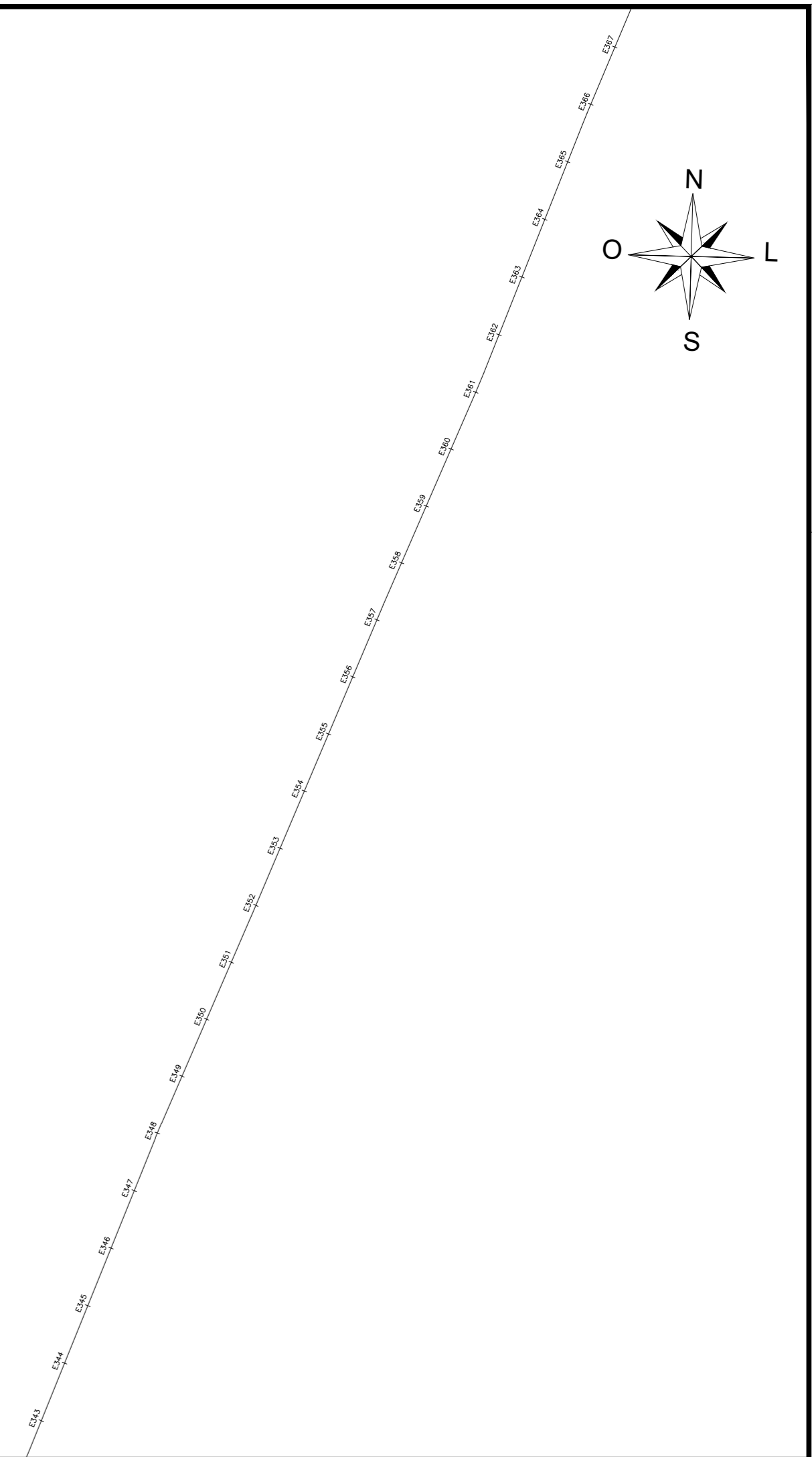
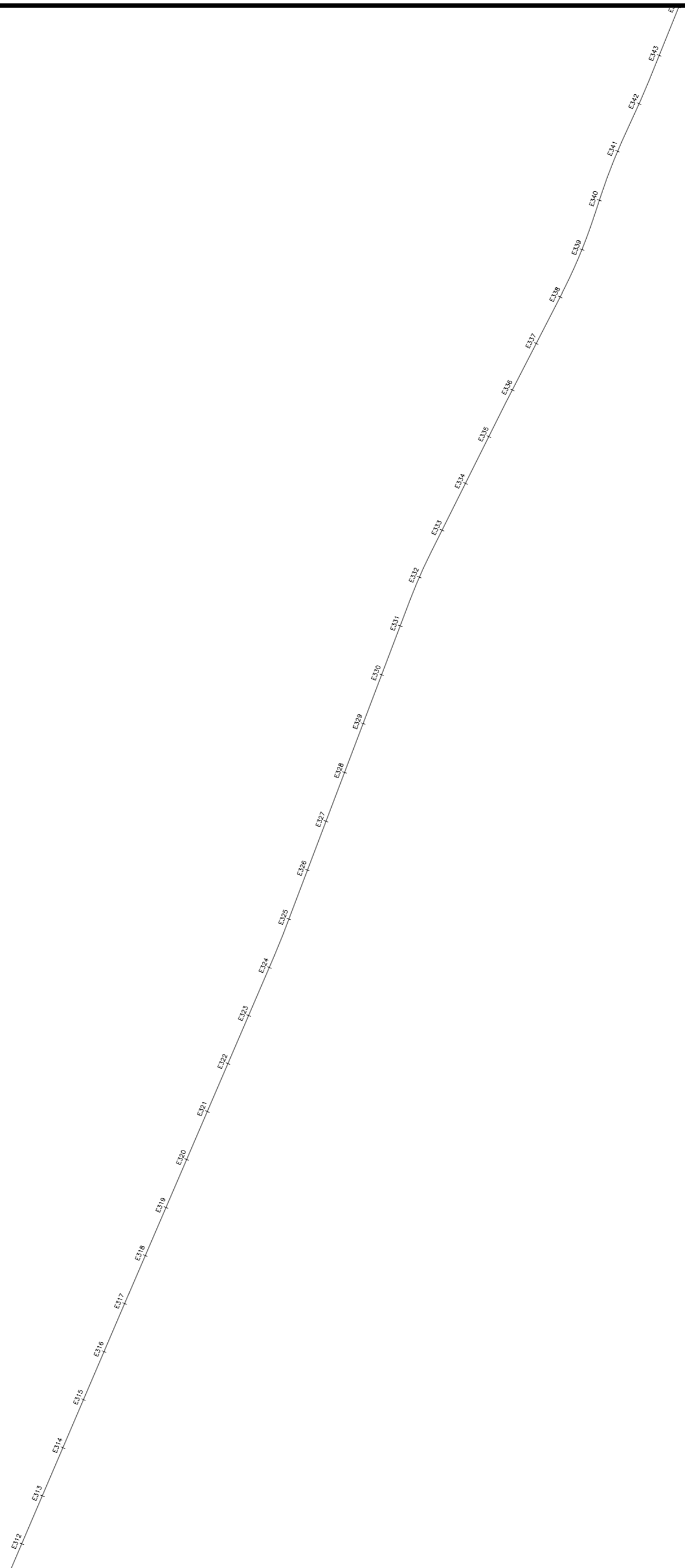
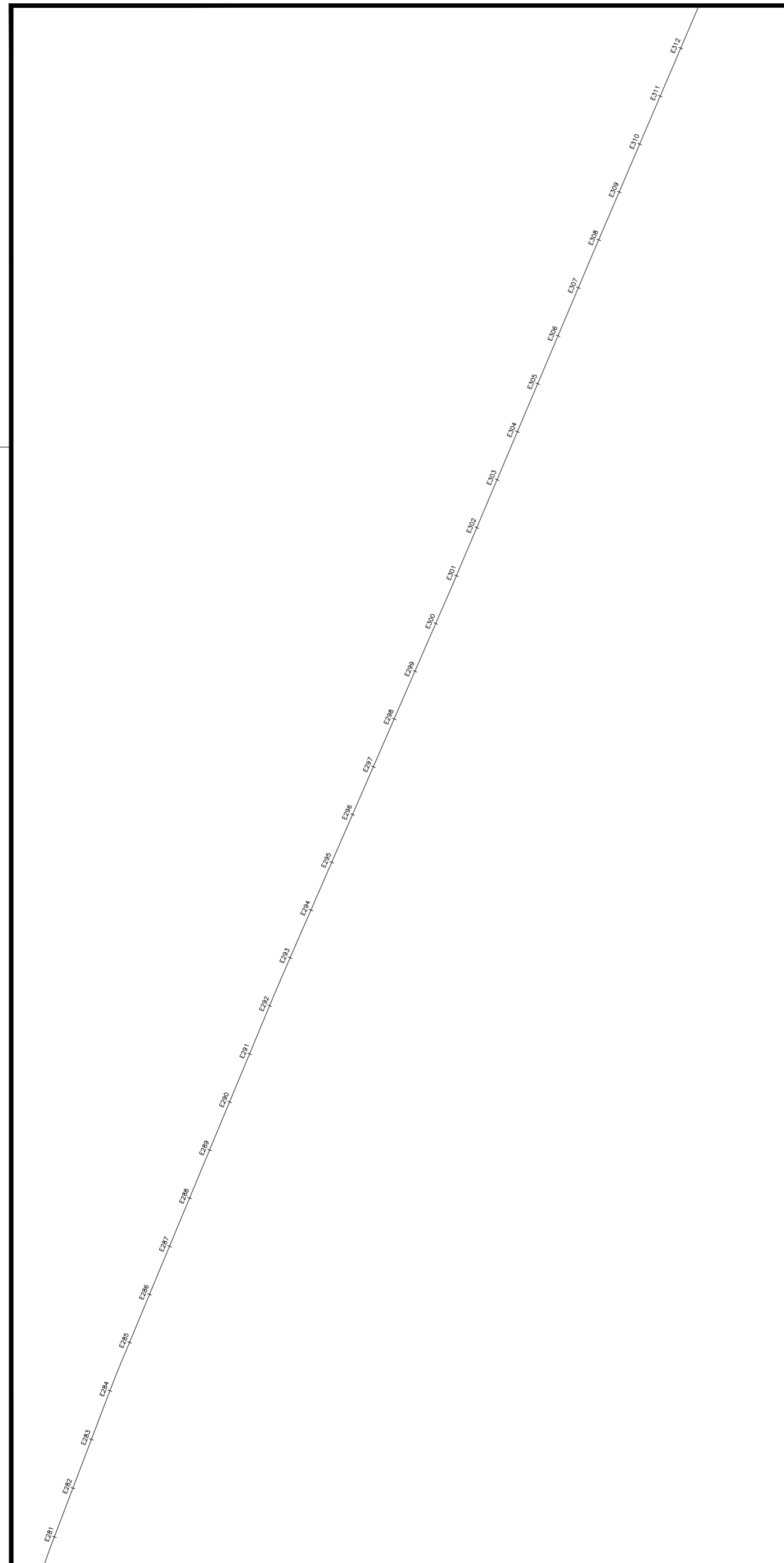

GOVERNO DO ESTADO DO PIAUÍ  
SECRETARIA DE ESTADO DO TURISMO - SETUR

OBRA: RECUPERAÇÃO DE ESTRADAS VICINAIS GEMINIANO - PI  
 PROJETO: PLANTA BAIXA - PERFIL LONGITUDINAL  
 TRECHO 1: MILHÃS A BENTIVI

ESCALAS:  
INDICADAS  
 DATA:  
2023

AUTONOMIA DO PROJETO:  
 Juliano Lopes de Oliveira Moura Fé  
 Engenheiro Civil



PRANCHA:  
**4/16**

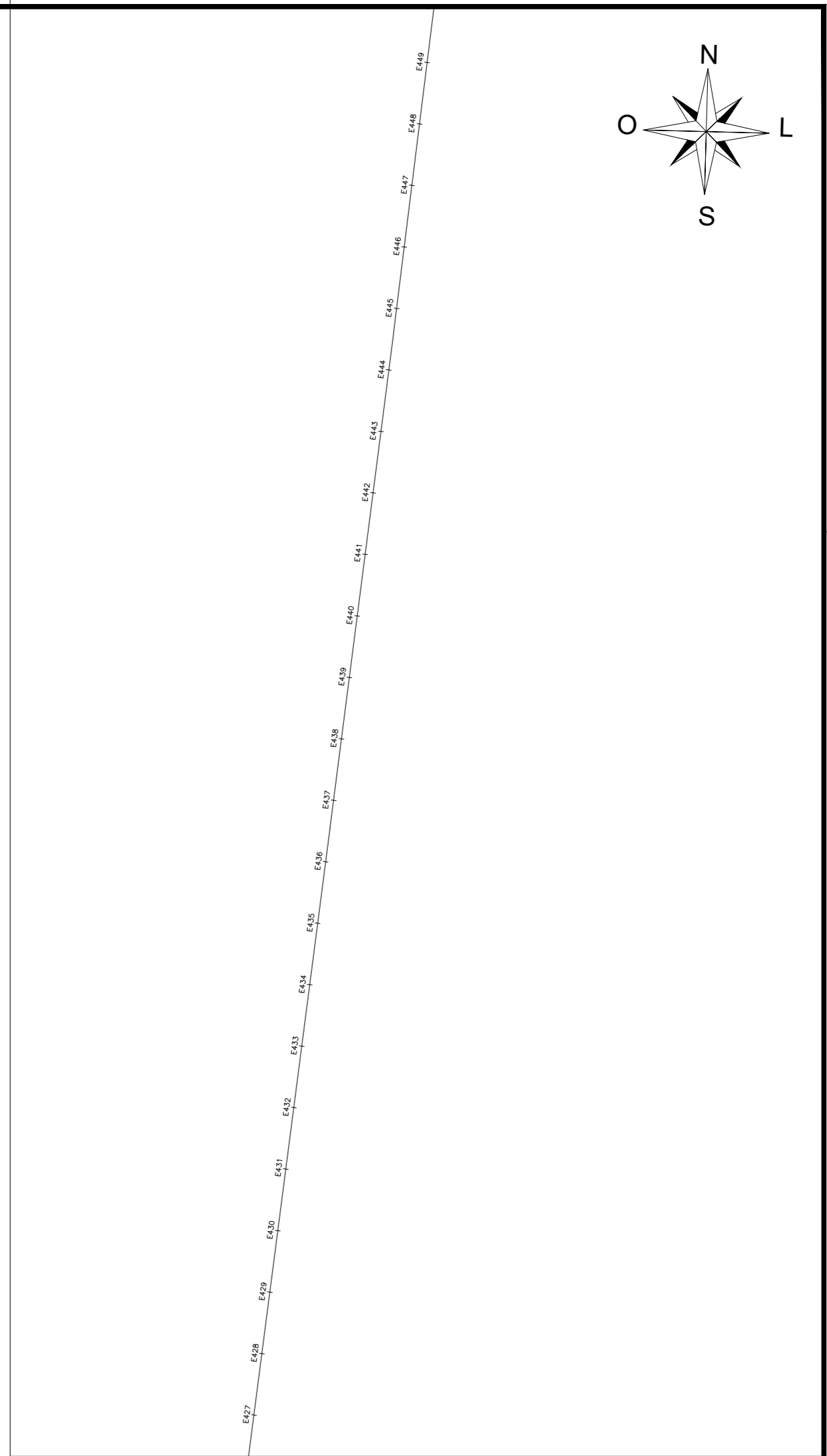
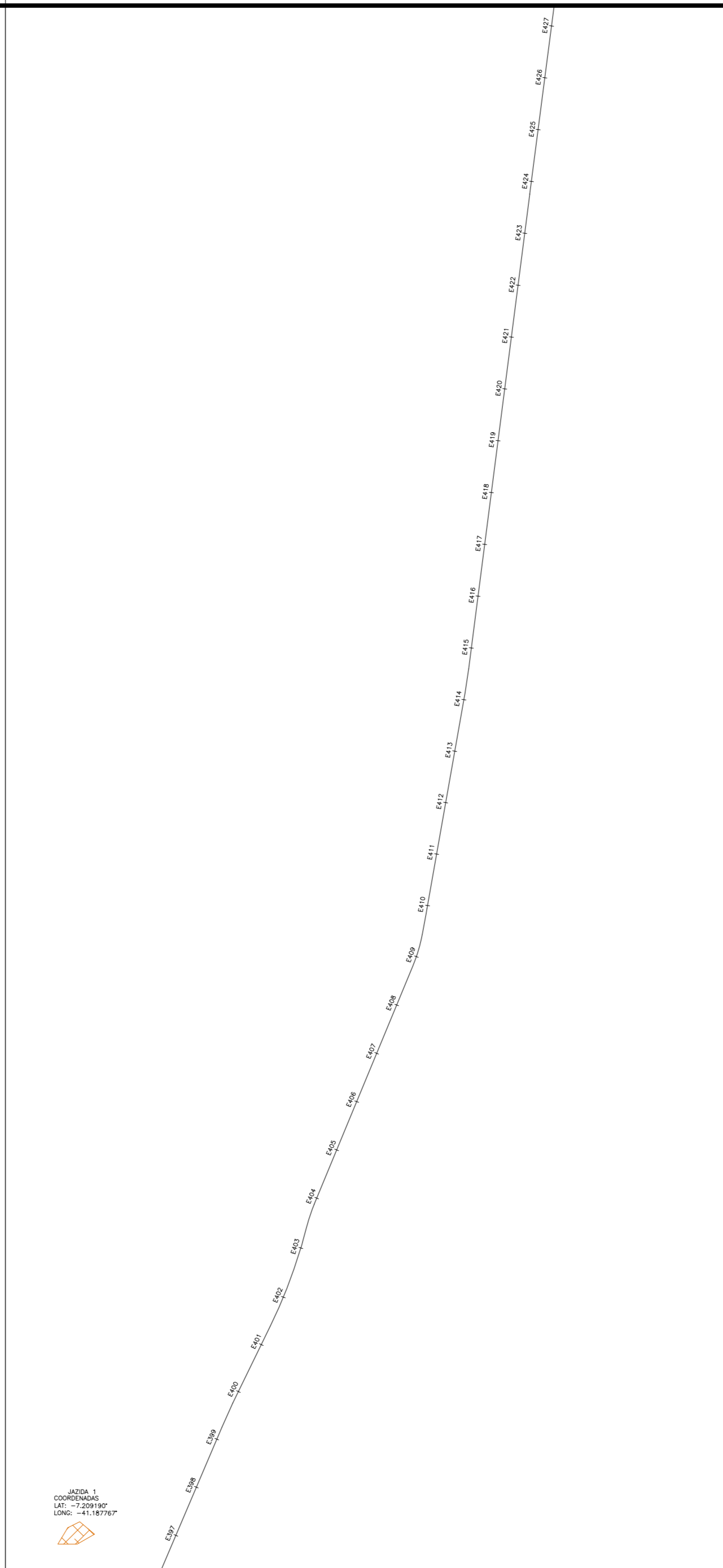
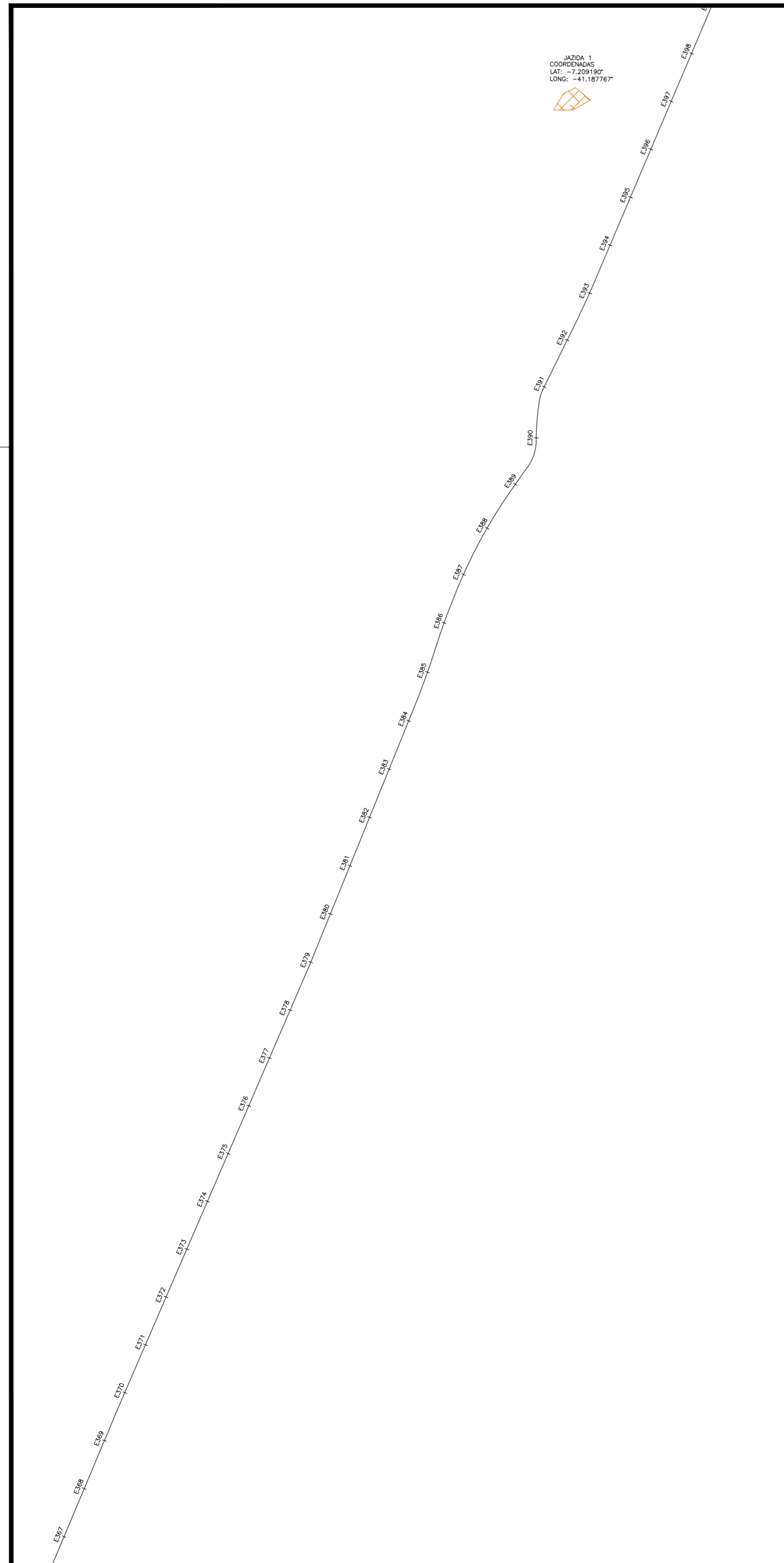

GOVERNO DO ESTADO DO PIAUÍ  
SECRETARIA DE ESTADO DO TURISMO - SETUR

OBRA: RECUPERAÇÃO DE ESTRADAS VICINAIS GEMINIANO - PI  
PROJETO: PLANTA BAIXA - PERFIL LONGITUDINAL  
TRECHO 1: MILHÃS A BENTIVI

ESCALAS:  
INDICADAS  
DATA:  
2023

AUTONOMIA DO PROJETO:  
Juliano Lopes de Oliveira Moura Fé  
Engenheiro Civil



PRANCHA:  
**5/16**

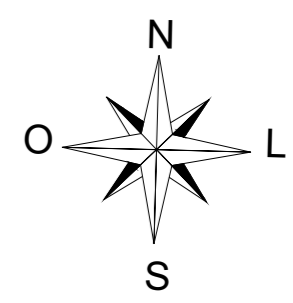
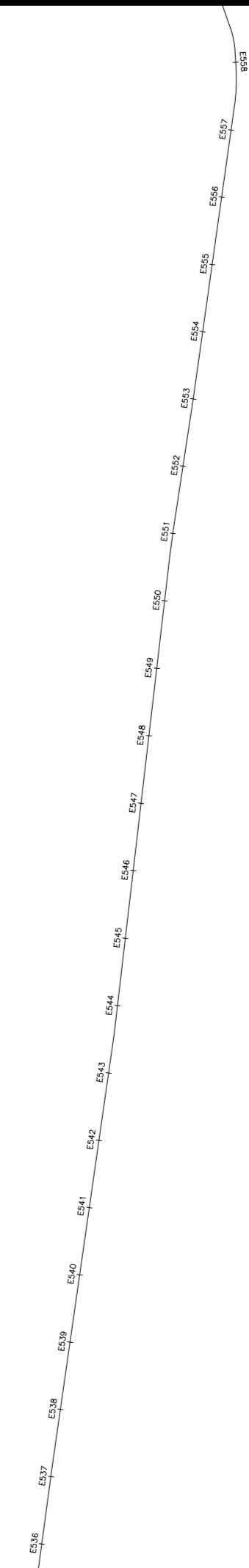
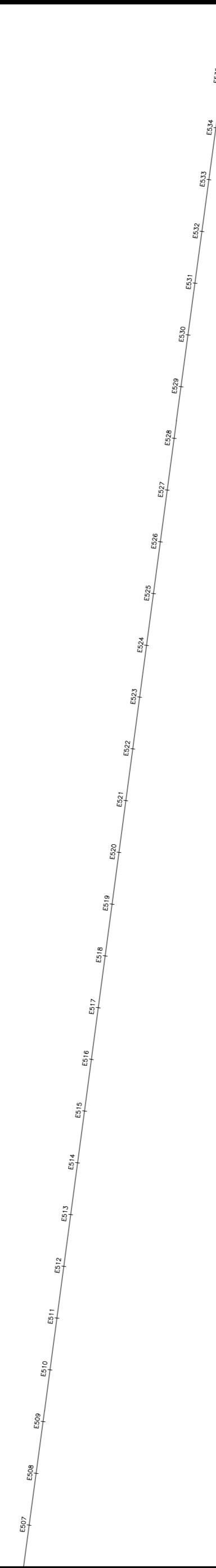
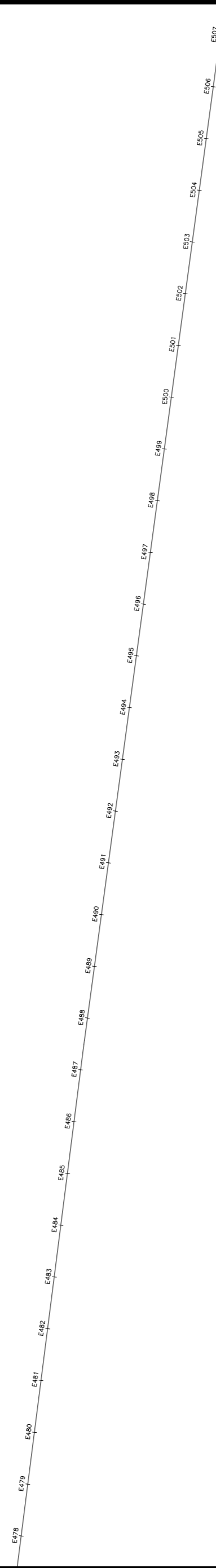
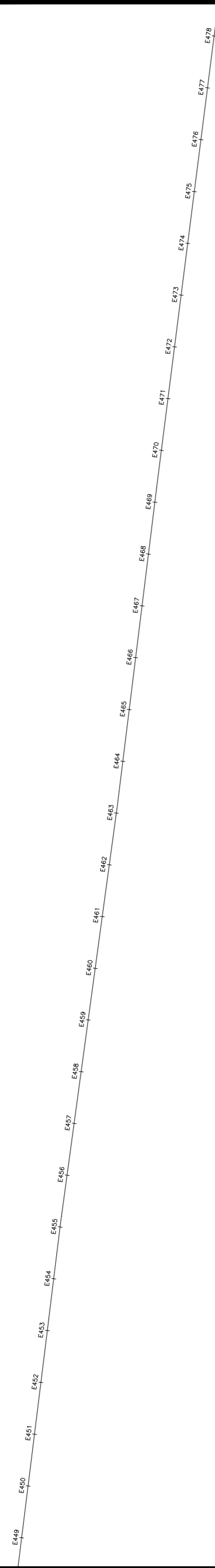

GOVERNO DO ESTADO DO PIAUÍ  
SECRETARIA DE ESTADO DO TURISMO - SETUR

OBRA: RECUPERAÇÃO DE ESTRADAS VICINAIS GEMINIANO - PI  
PROJETO: PLANTA BAIXA - PERFIL LONGITUDINAL  
TRECHO 1: MILHÃS A BENTIVI

ESCALAS:  
INDICADAS

DATA:  
2023

AUTONOMIA DO PROJETO:  
Juliano Lopes de Oliveira Moura Fé  
Engenheiro Civil



PRANCHA:  
**6/16**

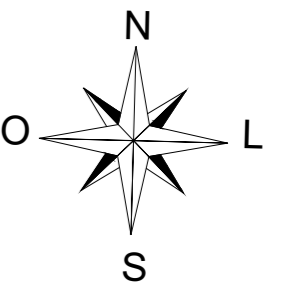
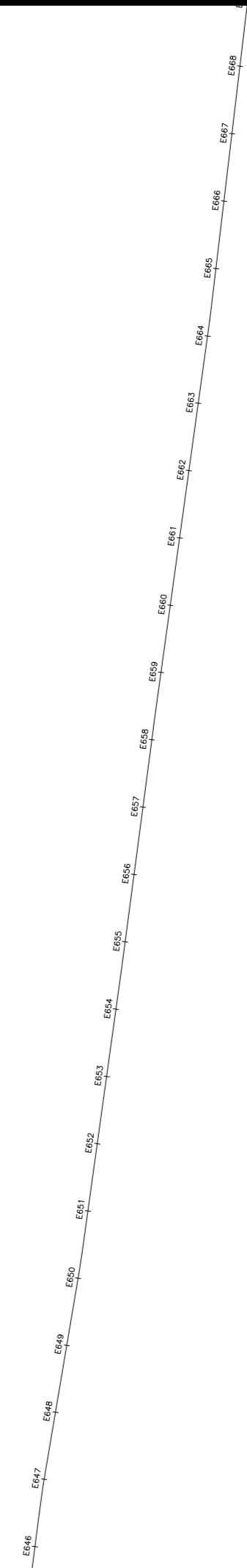
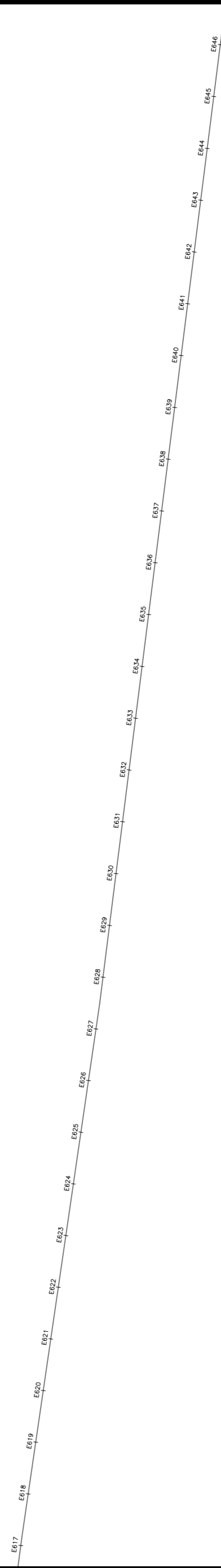
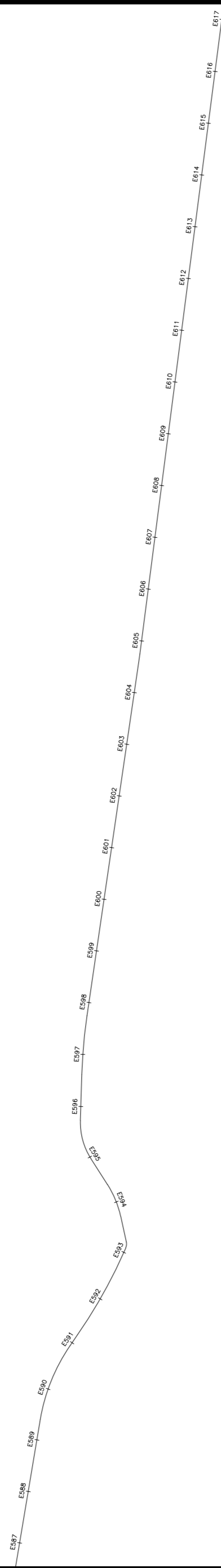
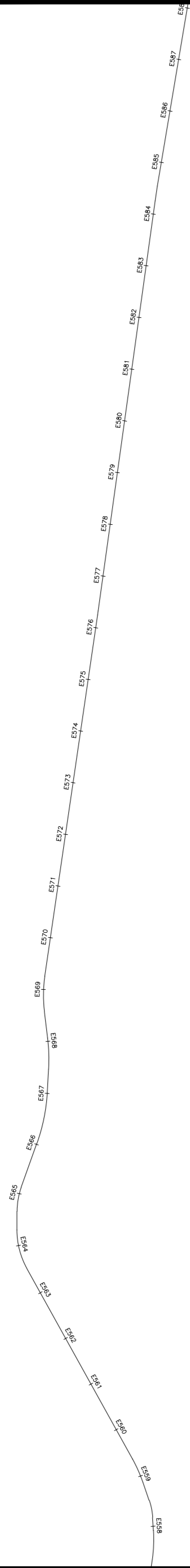

GOVERNO DO ESTADO DO PIAUÍ  
SECRETARIA DE ESTADO DO TURISMO - SETUR

OBRA: RECUPERAÇÃO DE ESTRADAS VICINAIS GEMINIANO - PI  
PROJETO: PLANTA BAIXA - PERFIL LONGITUDINAL  
TRECHO 1: MILHÃS A BENTIVI

ESCALAS:  
INDICADAS

DATA:  
2023

AUTONOMIA DO PROJETO:  
Juliano Lopes de Oliveira Moura Fé  
Engenheiro Civil



PRANCHA:  
**7/16**

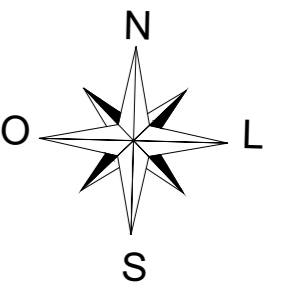
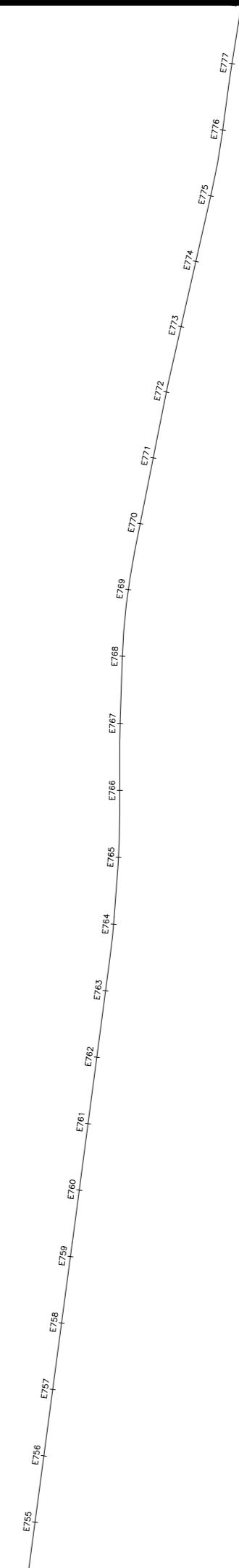
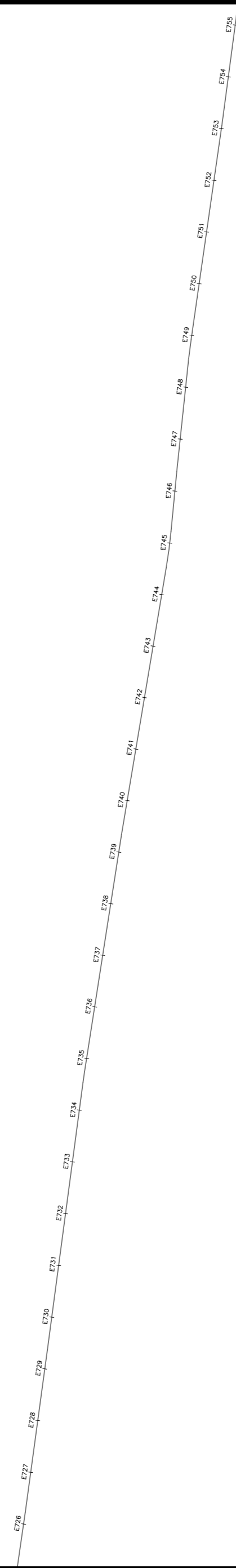
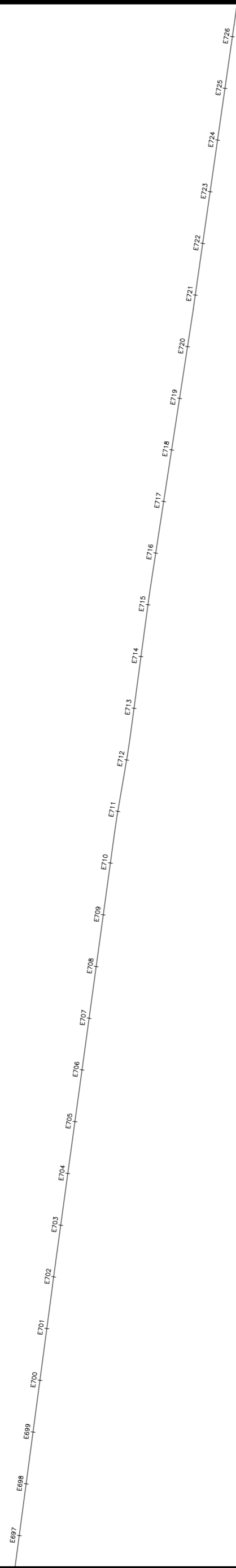
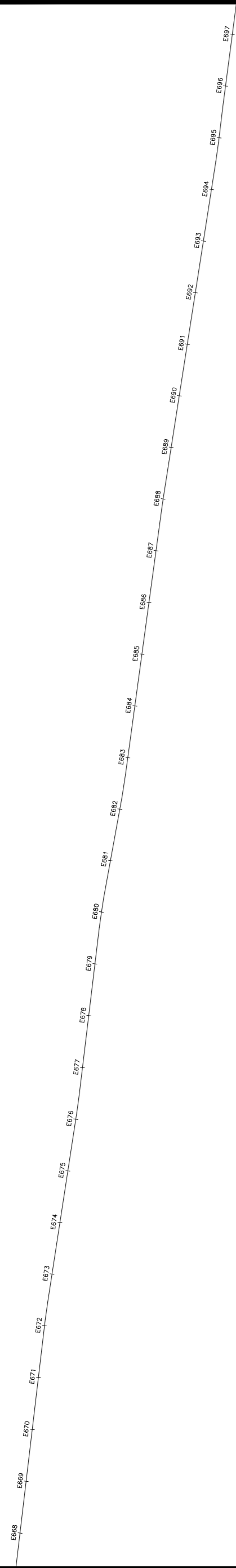

GOVERNO DO ESTADO DO PIAUÍ  
SECRETARIA DE ESTADO DO TURISMO - SETUR

OBRA: RECUPERAÇÃO DE ESTRADAS VICINAIS GEMINIANO - PI  
PROJETO: PLANTA BAIXA - PERFIL LONGITUDINAL  
TRECHO 1: MILHÃS A BENTIVI

ESCALAS:  
INDICADAS

DATA:  
2023

AUTONOMIA DO PROJETO:  
Juliano Lopes de Oliveira Moura Fé  
Engenheiro Civil

*Juliano Lopes de Oliveira Moura Fé*  
ENGENHEIRO CIVIL  
CREA/PI 19188/2022

PRANCHA:  
**8/16**



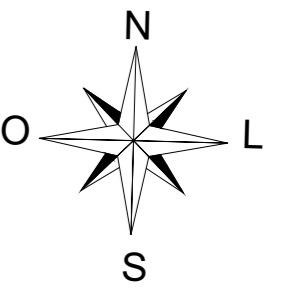
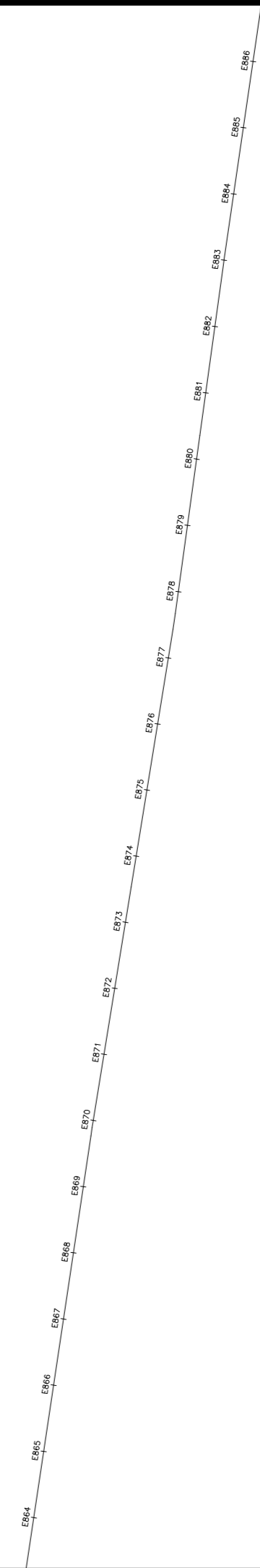
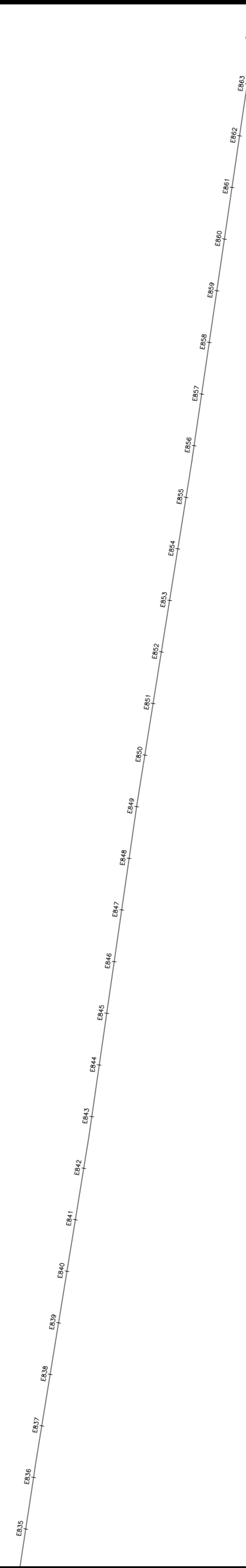
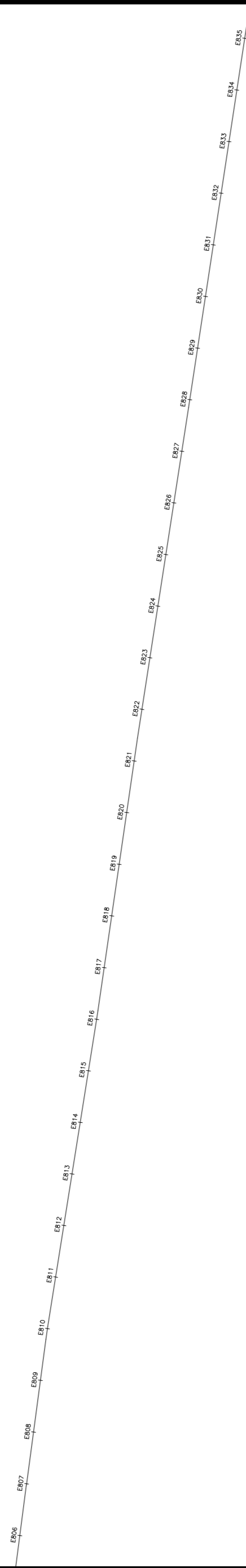
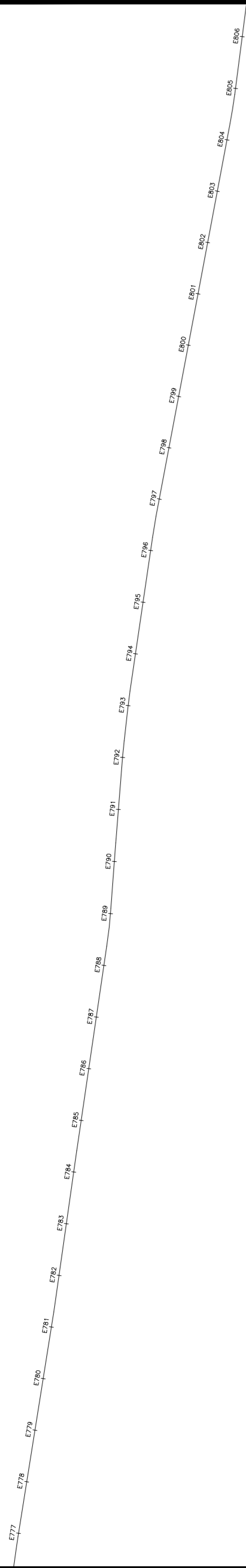

GOVERNO DO ESTADO DO PIAUÍ  
SECRETARIA DE ESTADO DO TURISMO - SETUR

OBRA: RECUPERAÇÃO DE ESTRADAS VICINAIS GEMINIANO - PI  
PROJETO: PLANTA BAIXA - PERFIL LONGITUDINAL  
TRECHO 1: MILHÃS A BENTIVI

ESCALAS:  
INDICADAS

DATA:  
2023

AUTONOMIA DO PROJETO:  
Juliano Lopes de Oliveira Moura Fé  
Engenheiro Civil

*Juliano Lopes de Oliveira Moura Fé*  
ENGENHEIRO CIVIL  
CREA-PI 19188/2022

PRANCHA:  
**9/16**

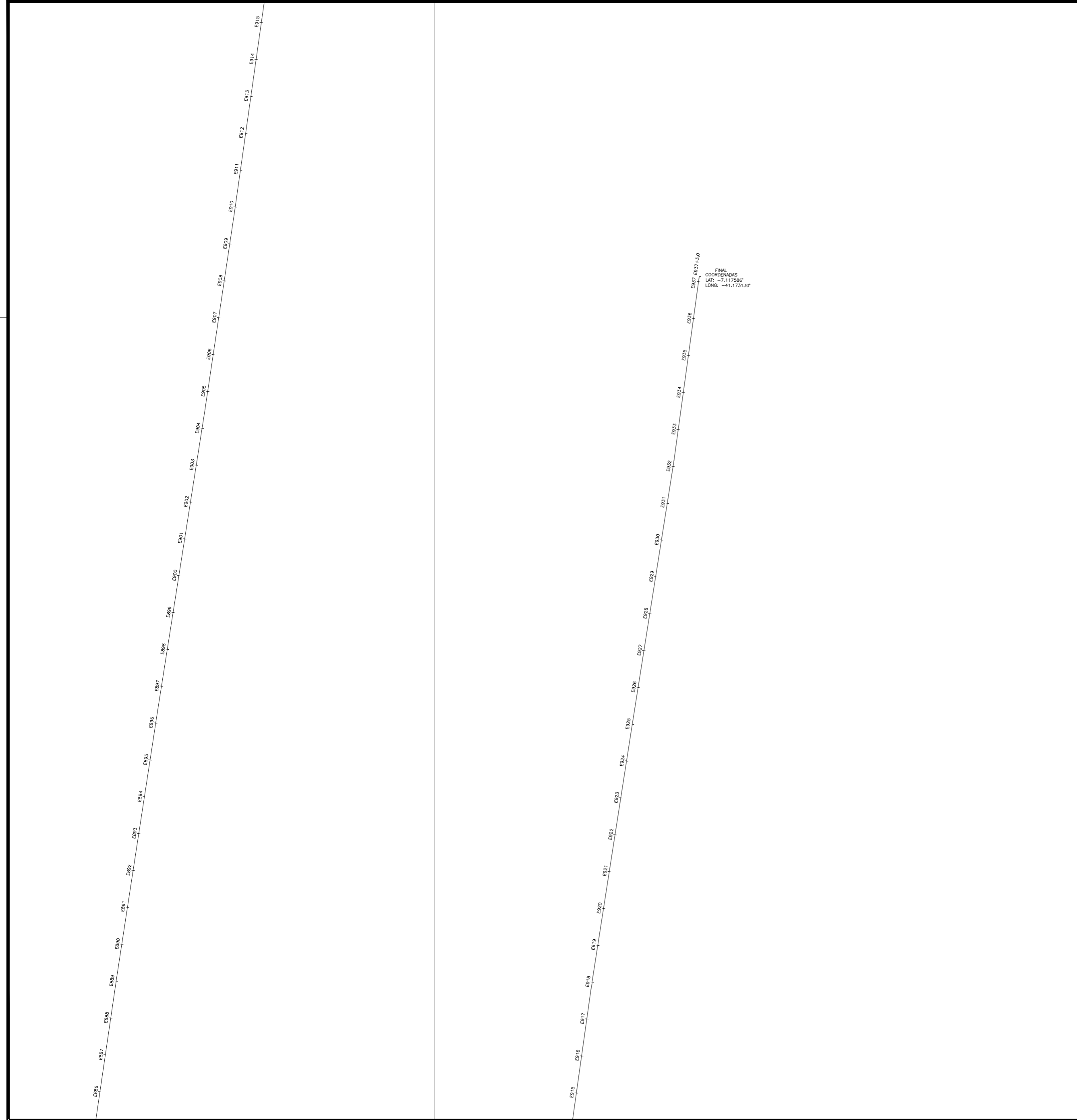
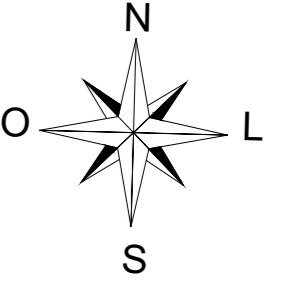

GOVERNO DO ESTADO DO PIAUÍ  
SECRETARIA DE ESTADO DO TURISMO - SETUR

OBRA: RECUPERAÇÃO DE ESTRADAS VICINAIS GEMINIANO - PI  
PROJETO: PLANTA BAIXA - PERFIL LONGITUDINAL  
TRECHO 1: MILHÃNS A BENTIVI

ESCALAS:  
INDICADAS

DATA:  
2023

AUTONOMIA DO PROJETO:  
Juliano Lopes de Oliveira Moura Fé  
Engenheiro Civil

PRANCHA:  
**10/16**

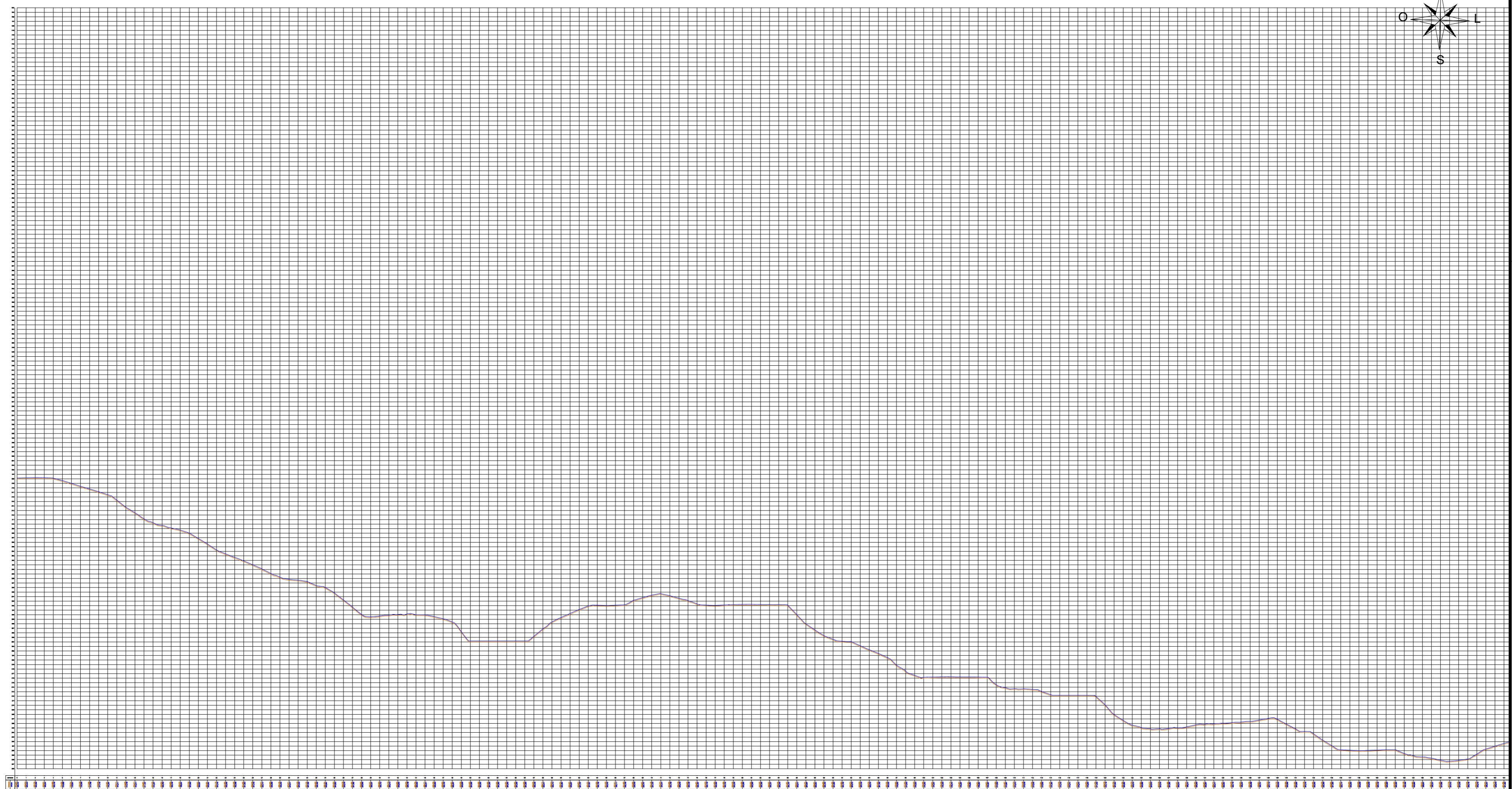
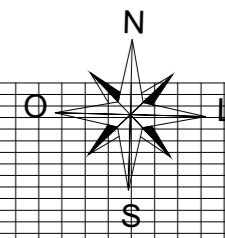

GOVERNO DO ESTADO DO PIAUÍ  
SECRETARIA DE ESTADO DO TURISMO - SETUR

OBRA: RECUPERAÇÃO DE ESTRADAS VICINAIS GEMINIANO - PI  
PROJETO: PLANTA BAIXA - PERFIL LONGITUDINAL  
TRECHO 1: MILHÃNS A BENTIVI

ESCALAS:  
INDICADAS

DATA:  
2023

AUTONOMIA DO PROJETO:  
Juliano Lopes de Oliveira Moura Fé  
Engenheiro Civil

  
ENGENHEIRO CIVIL  
CREA-PI 19188/2028

PRANCHA:  
**11/16**

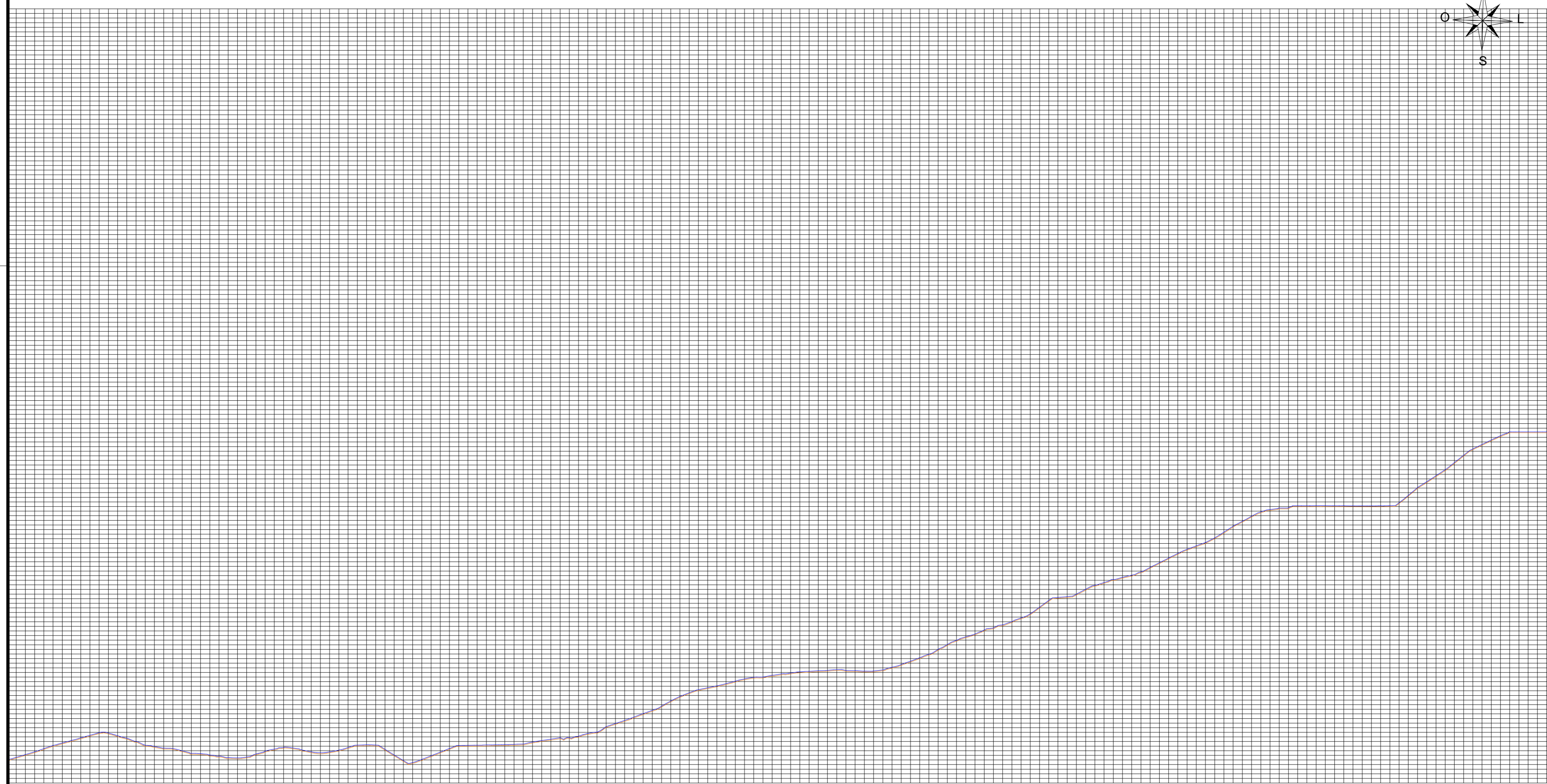
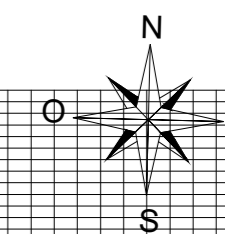

GOVERNO DO ESTADO DO PIAUÍ  
SECRETARIA DE ESTADO DO TURISMO - SETUR

OBRA: RECUPERAÇÃO DE ESTRADAS VICINAIS GEMINIANO - PI  
PROJETO: PLANTA BAIXA - PERFIL LONGITUDINAL  
TRECHO 1: MILHÃNS A BENTIVI

ESCALAS:  
INDICADAS

DATA:  
2023

AUTONOMIA DO PROJETO:  
Juliano Lopes de Oliveira Moura Fé  
Engenheiro Civil



PRANCHA:  
**12/16**

TRECHO 01 - MILHÃES A BENTIVI

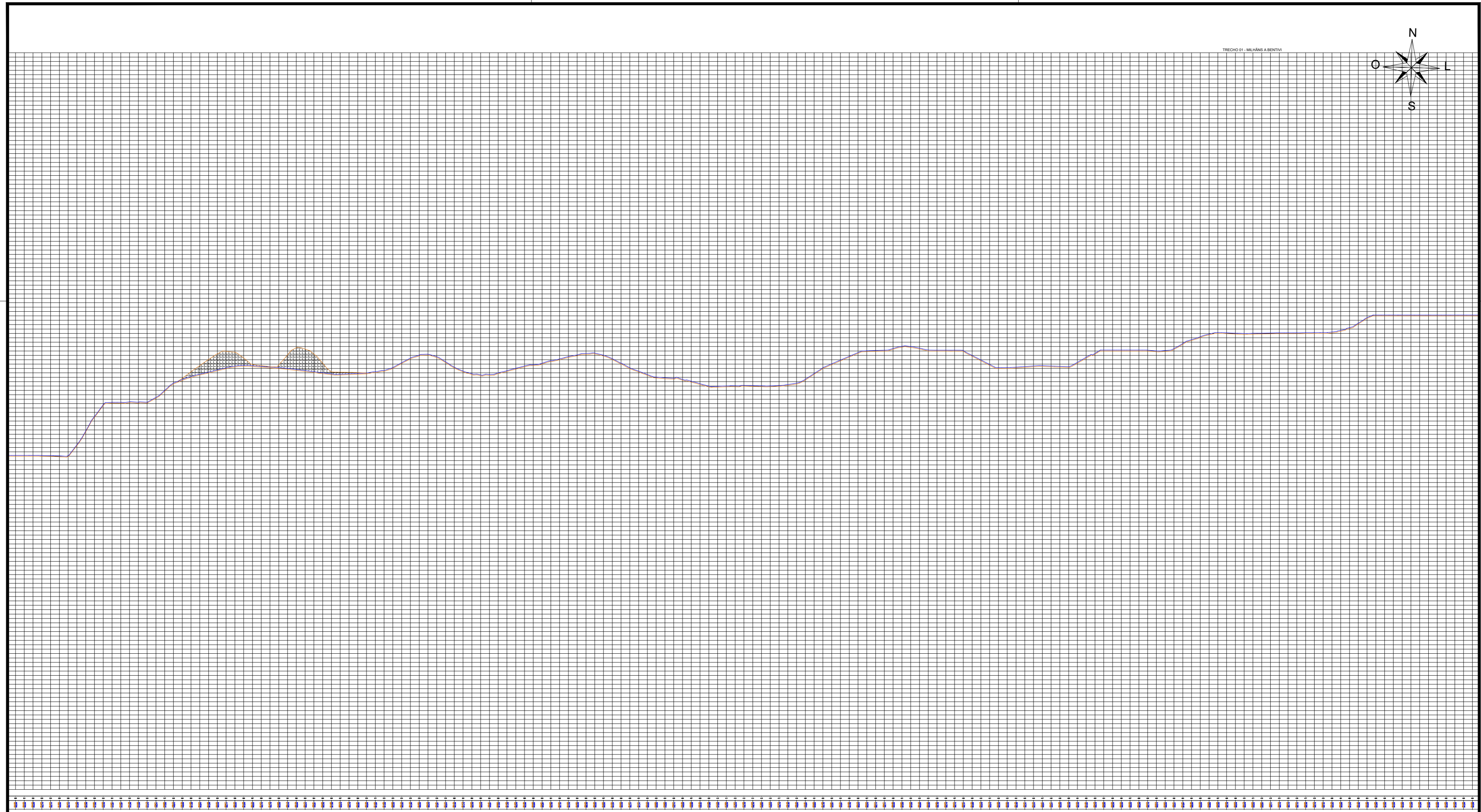
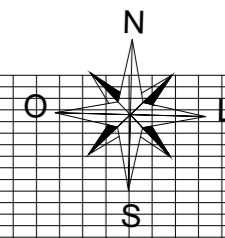

LEGENDA: RAMPA A SER DEMOLIDA 

GOVERNO DO ESTADO DO PIAUÍ  
SECRETARIA DE ESTADO DO TURISMO - SETUR

OBRA: RECUPERAÇÃO DE ESTRADAS VICINAIS GEMINIANO - PI  
PROJETO: PLANTA BAIXA - PERFIL LONGITUDINAL  
TRECHO 1: MILHÃES A BENTIVI

ESCALAS:  
INDICADAS

DATA:  
2023

AUTONOMIA DO PROJETO:  
Juliano Lopes de Oliveira Moura Fé  
Engenheiro Civil



PRANCHA:  
**13/16**

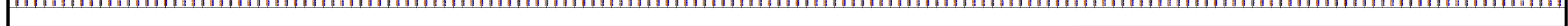
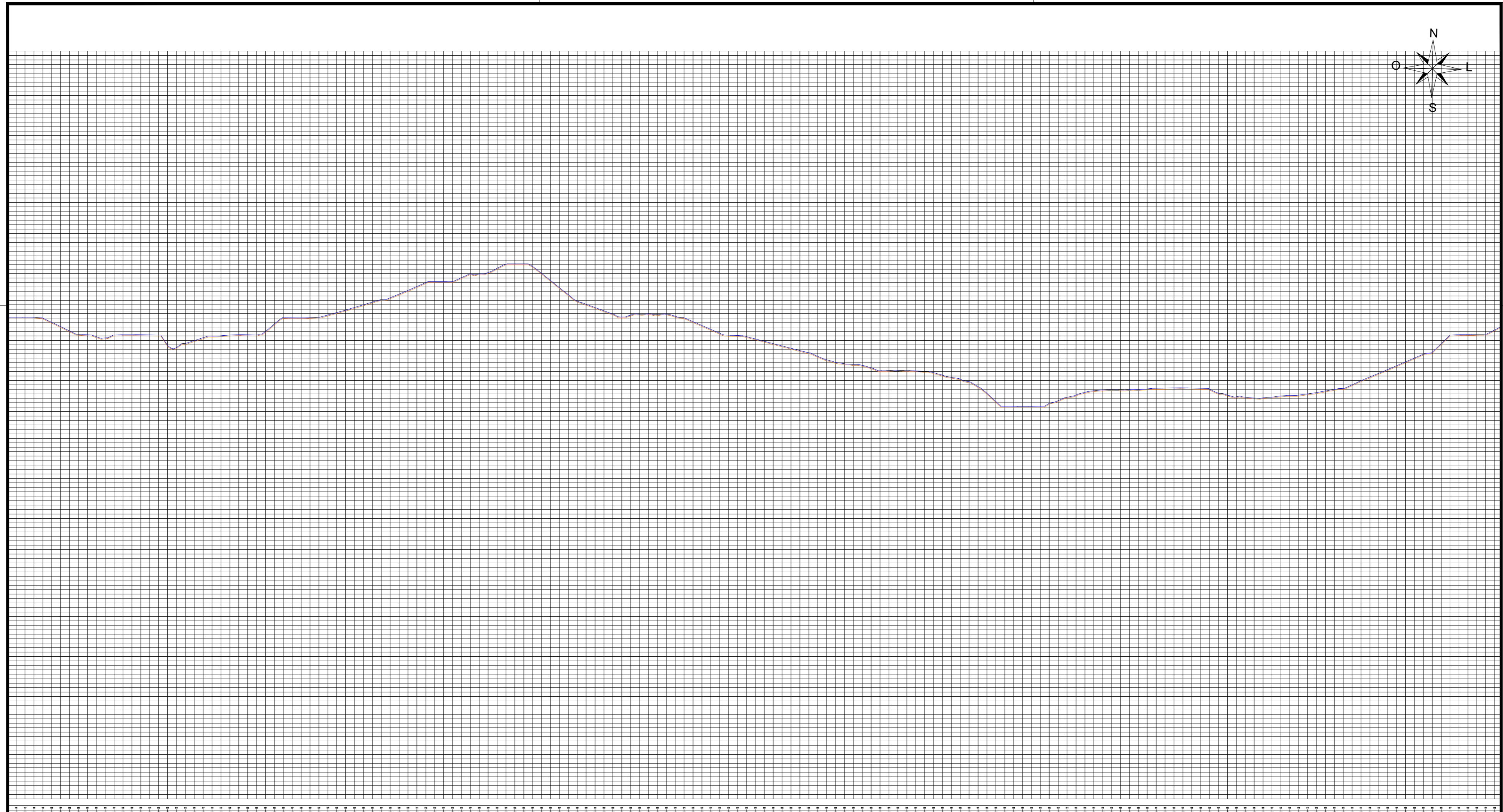
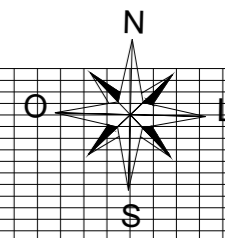

GOVERNO DO ESTADO DO PIAUÍ  
SECRETARIA DE ESTADO DO TURISMO - SETUR

OBRA: RECUPERAÇÃO DE ESTRADAS VICINAIS GEMINIANO - PI  
PROJETO: PLANTA BAIXA - PERFIL LONGITUDINAL  
TRECHO 1: MILHÃNS A BENTIVI

ESCALAS:  
INDICADAS

DATA:  
2023

AUTONOMIA DO PROJETO:  
Juliano Lopes de Oliveira Moura Fé  
Engenheiro Civil



PRANCHA:  
**14/16**

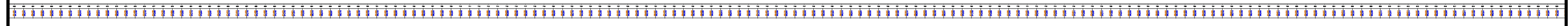
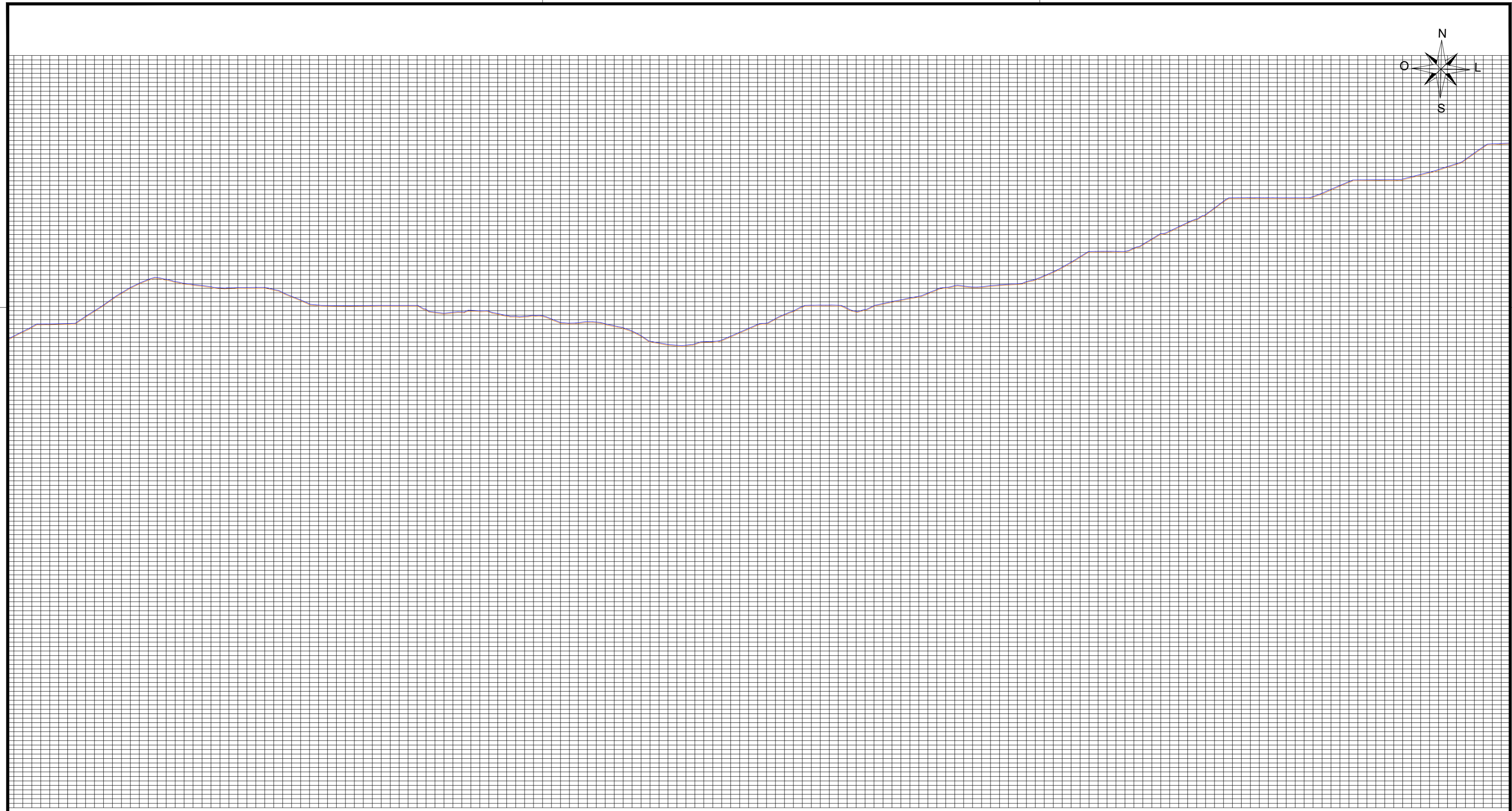
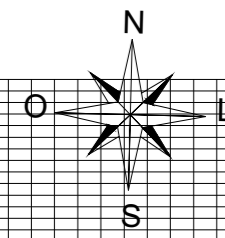

GOVERNO DO ESTADO DO PIAUÍ  
SECRETARIA DE ESTADO DO TURISMO - SETUR

OBRA: RECUPERAÇÃO DE ESTRADAS VICINAIS GEMINIANO - PI  
PROJETO: PLANTA BAIXA - PERFIL LONGITUDINAL  
TRECHO 1: MILHÃNS A BENTIVI

ESCALAS:  
INDICADAS

DATA:  
2023

AUTONOMIA DO PROJETO:  
Juliano Lopes de Oliveira Moura Fé  
Engenheiro Civil

Juliano Lopes de Oliveira Moura Fé  
ENGENHEIRO CIVIL  
CRECAP 15148/2023

PRANCHA:  
**15/16**

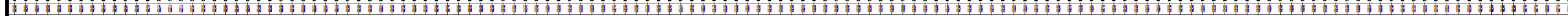
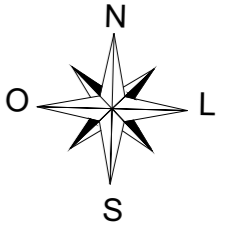

GOVERNO DO ESTADO DO PIAUÍ  
SECRETARIA DE ESTADO DO TURISMO - SETUR

OBRA: RECUPERAÇÃO DE ESTRADAS VICINAIS GEMINIANO - PI  
PROJETO: PLANTA BAIXA - PERFIL LONGITUDINAL  
TRECHO 1: MILHÃNS A BENTIVI

ESCALAS:  
INDICADAS

DATA:  
2023

AUTONOMIA DO PROJETO:  
Juliano Lopes de Oliveira Moura Fé  
Engenheiro Civil

PRANCHA:  
**16/16**